

Sources:  
Traffic Impact Study - C&S, 2006

**ALTERNATIVE G DIRECT EFFECTS  
TRAFFIC VOLUMES - TYPICAL WEEKDAY P.M. PEAK**

**FIGURE  
4.8-1**

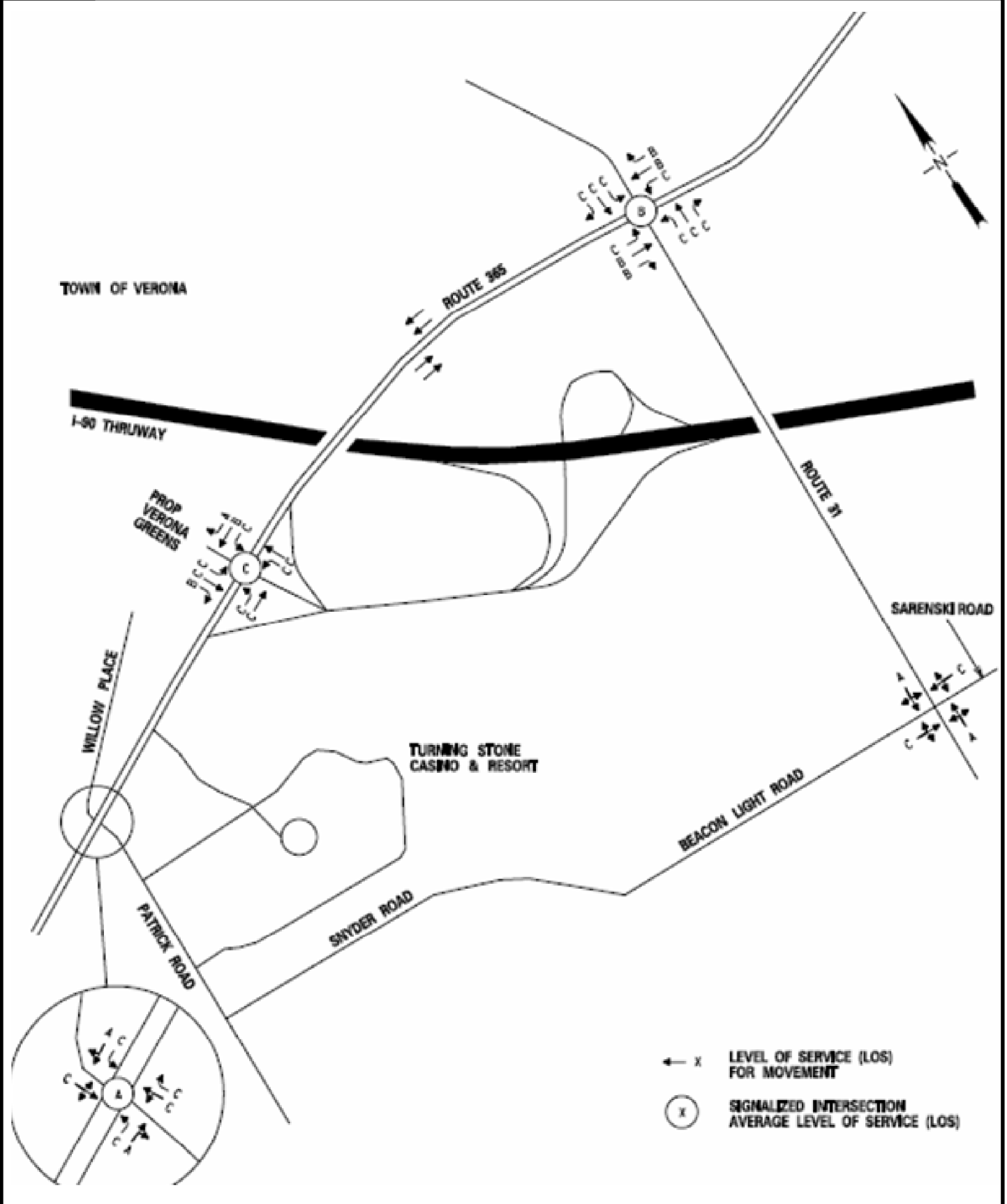

Sources:  
Traffic Impact Study - C&S, 2006

**ALTERNATIVE G DIRECT EFFECTS  
LEVEL OF SERVICE - TYPICAL WEEKDAY P.M. PEAK**

**FIGURE  
4.8-2**



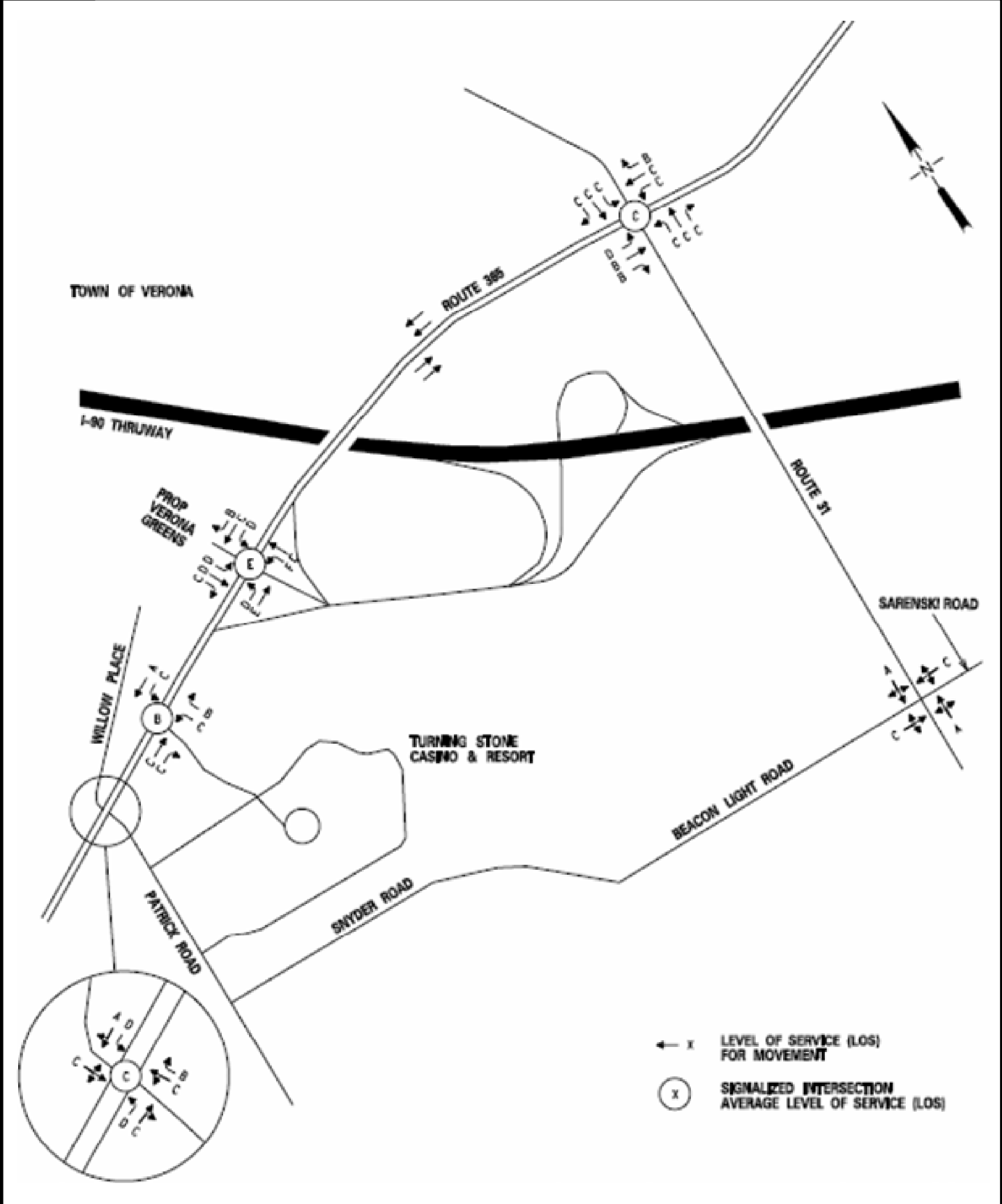

Sources:  
Traffic Impact Study - C&S, 2006

**INDIRECT EFFECTS - LEVEL OF SERVICE  
TYPICAL WEEKDAY P.M. PEAK**

**FIGURE  
4.8-4**

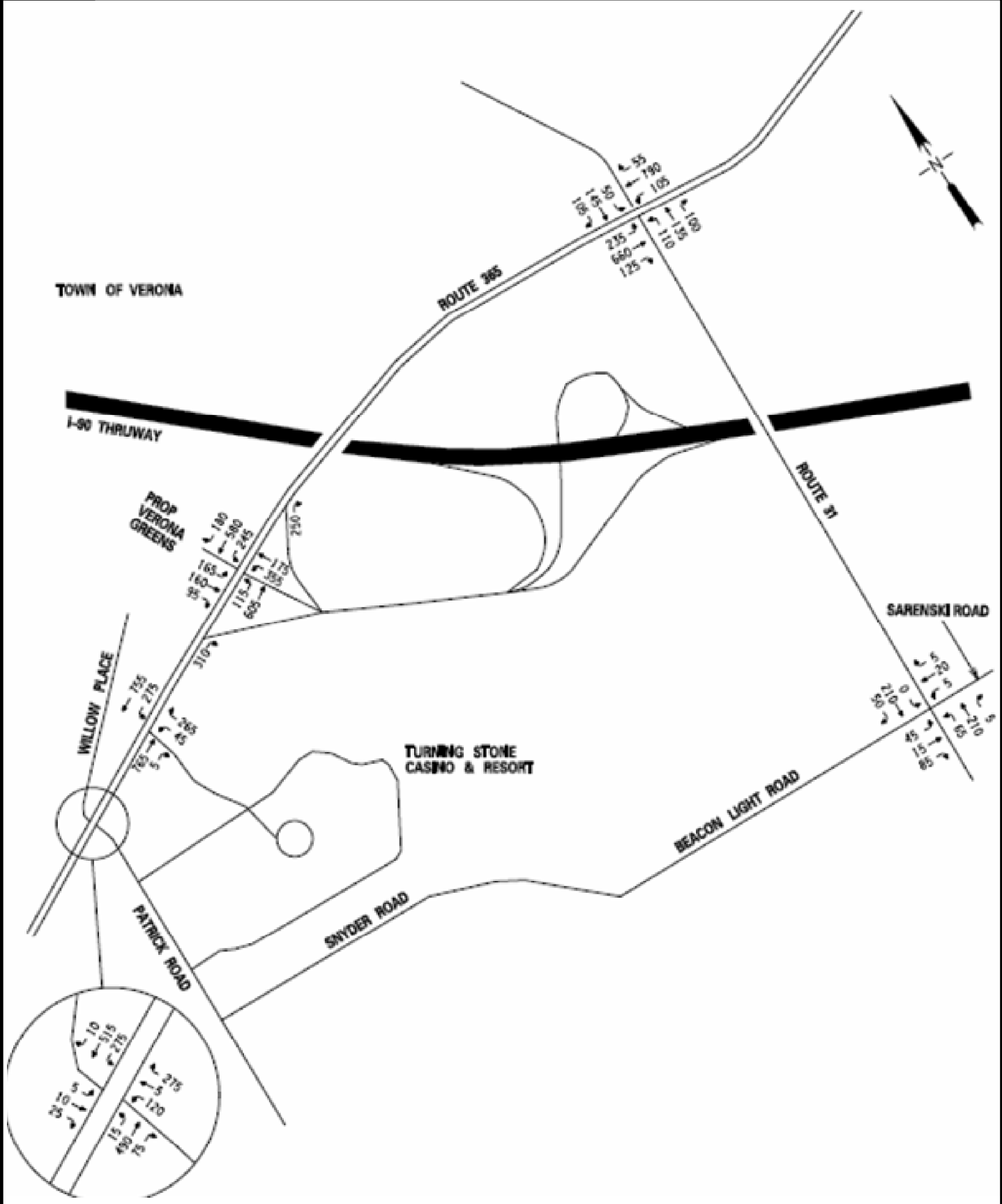

Sources:  
Traffic Impact Study - C&S, 2006

**BACKGROUND TRAFFIC VOLUMES  
TYPICAL WEEKDAY P.M. PEAK**

**FIGURE  
4.8-5**

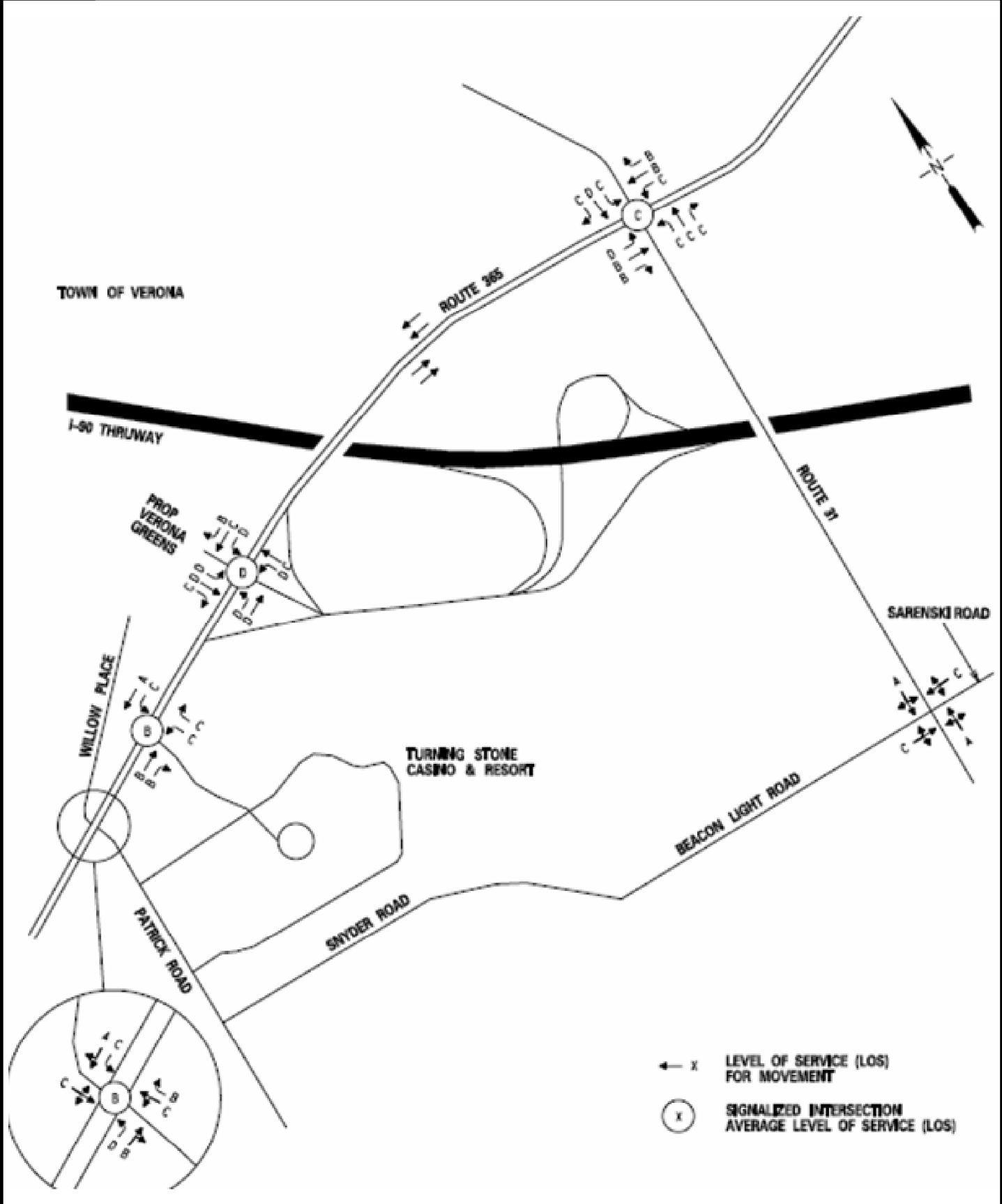

Sources:  
Traffic Impact Study - C&S, 2006

**BACKGROUND LEVEL OF SERVICE  
TYPICAL WEEKDAY P.M. PEAK**

**FIGURE  
4.8-6**



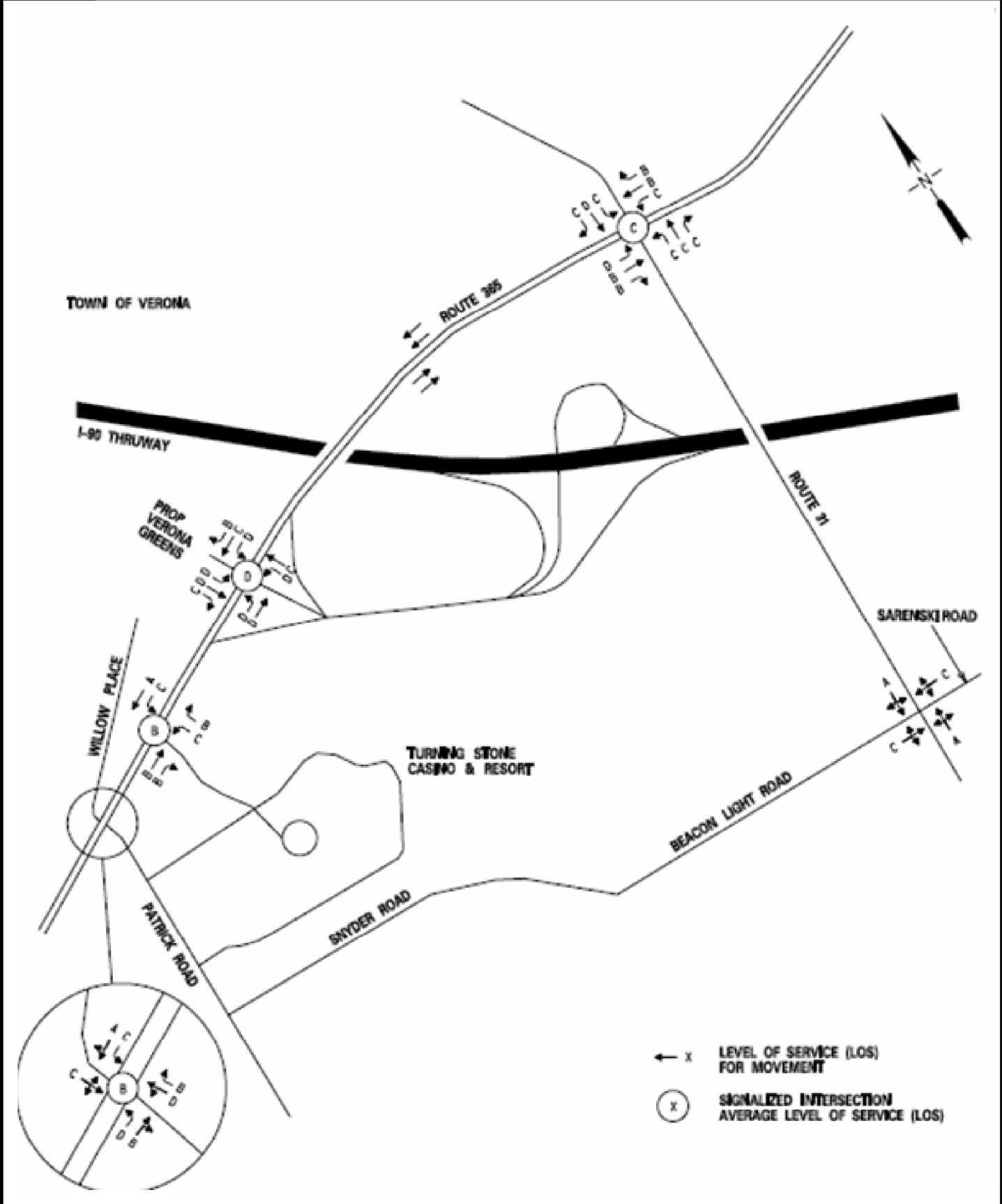

Sources:  
Traffic Impact Study - C&S, 2006

**PROGRAM DEVELOPMENT - LEVEL OF SERVICE  
TYPICAL WEEKDAY P.M. PEAK**

**FIGURE  
4.8-8**